

RC1-SS Remote Control

Weatherproof Receiver

Water Resistant Transmitter

Sunset Sensor™



Please check your local electrical safety regulations before proceeding to install this remote control, particularly when wiring to an underwater pool light.

Some of the installation steps in this manual may need to be carried out by a licensed electrician.

Thank You.

Thank you for choosing the **RC1-SS** Remote Control for your low voltage switching needs.

Please take the time to fully read through this manual to ensure that you install the remote control correctly and take full advantage of its features.

Keep this manual in a safe place in case you need to refer to it at a later date.

If your **RC1-SS** requires servicing at any time, please contact the distributor from whom you purchased the light.

Contents

Unpacking your **RC1-SS** Remote Control Kit. 2

Electrical Installation 3

Using the Remote Control 4

 Setting the Sunset Sensor function 4

Changing RC-3T button assignments or “learning” new RC1-SS Receiver. 5

Wiring for multiple pool lights and other 12V AC/DC electrical devices 6

Replacing the Battery in RC-3T Remote Control Transmitter. 7

Warranty 8

Contact Information 8

Unpacking your RC1-SS Remote Control Kit

Carefully unpack your RC1-SS Remote Control and check that the following accessories have been included.



RC1-SS
Remote Control
Receiver with
Sunset Sensor



RC-3T
Remote Control
3 Button
Transmitter

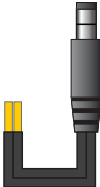

Transformer
to Remote
Power Cable

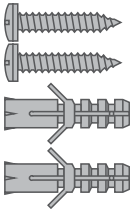

Self Tapping Screws x 4
Wall Plugs x 4

Electrical Installation

It may be compulsory for the hard wiring stage of this electrical installation to be done by a licensed electrician, if the RC1-SS will be controlling an underwater light. Please check with your local electrical authority if in doubt.

In some countries, such as Australia, it is compulsory for underwater lights to be fitted with their own transformer, i.e. you may not install multiple lights through one remote control and transformer. Please check with your local electrical authority if in doubt.

- Mount the RC1-SS Remote Control Power Switch close enough to the 12V AC/DC power supply to allow the cable to reach from the output of the transformer to the input of the RC1-SS. Use the masonry anchors supplied for brick or concrete walls.
- Plug the output cable from the 12V AC/DC power supply into the Input of the RC1-SS. A short length of cable with suitable plug has been pre-wired for your convenience.
- Unscrew the red and black output binding posts until the wiring holes are full exposed. Strip the low voltage accessory (e.g. pool light) power cable wires to approximately 10mm, then twist and push into the holes. Screw the binding posts into place tightly. For 12V AC, the wires can be connected either way around. For 12V DC, take care to fit positive to the red terminal and negative to the black terminal.

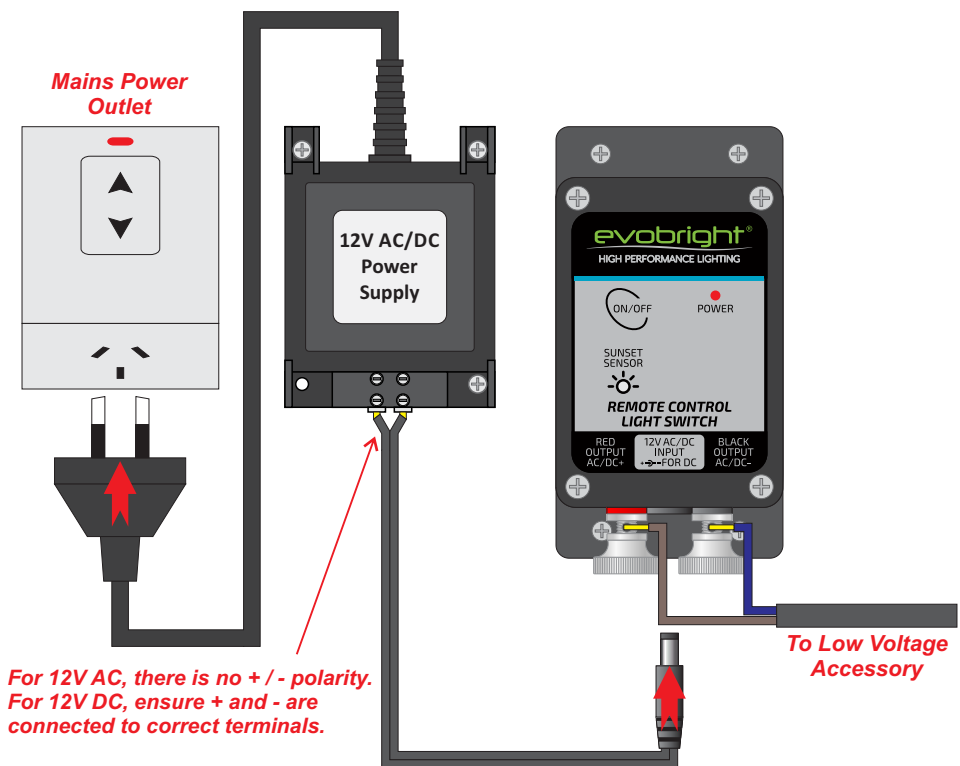

Using the Remote Control

RC1-SS Remote Control Receiver with Sunset Sensor

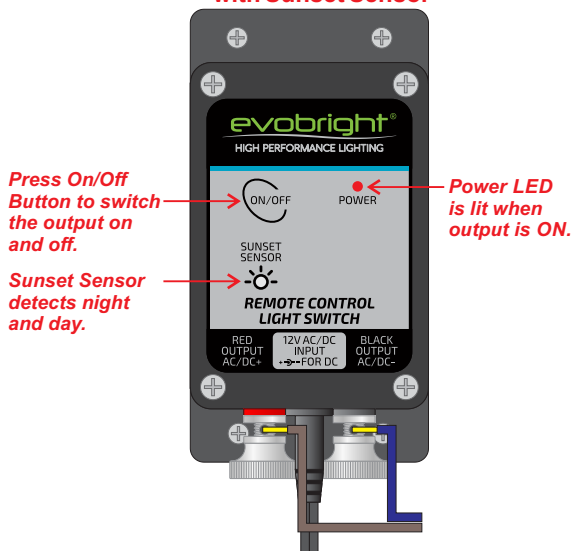

RC-3T Remote Control 3 Button Transmitter



**Press Button 1 on transmitter
to switch the output on and off.**

**To change button assignment
or “learn” a new RC1-SS receiver
unit, see instructions over the
page.**

Setting the Sunset function

The function of the Sunset Sensor can be user-set to your requirements using the On/Off button on the RC1-SS Receiver :

- Press AND HOLD the On/Off button for 5 seconds, until the Power LED starts to flash.
- The number of flashes indicate the currently selected Sunset Sensor mode. The flashes are in groups, with a 2 second pause between each group.
- Press the On/Off button to move from one program to the next, as per the list below.
- When the desired program has been selected, press AND HOLD the On/Off button for 5 seconds to save the new setting.

Flashes	Description of Mode
1	Sunset sensor is disabled. The output can only be switched on and off only by pressing the On/Off buttons on the Remote Control receiver or transmitter.
2	Output will switch on at sunset and off at sunrise. The On/Off buttons on the Remote Control receiver and transmitter have no effect.
3	Output will switch on and sunset and off 2 hours later. The On/Off buttons on the Remote Control receiver and transmitter can be used to override the sunset sensor function. See below.
4	Output will switch on and sunset and off 4 hours later. The On/Off buttons on the Remote Control receiver and transmitter can be used to override the sunset sensor function. See below.
5	Output will switch on and sunset and off 6 hours later. The On/Off buttons on the Remote Control receiver and transmitter can be used to override the sunset sensor function. See below.
6	Output will switch on and sunset and off 8 hours later. The On/Off buttons on the Remote Control receiver and transmitter can be used to override the sunset sensor function. See below.

- In modes 3 to 6, the On/Off button and remote control can be used to switch the light on or off manually, regardless of day/night cycle. The **RC1-SS** will resume the sunset sensing program within one sunrise or one sunset.

Changing RC-3T button assignments or “learning” new RC1-SS Receiver

Since this procedure does not require any wiring to be disconnected or changed, no electrical qualification is required. However, please take care at all times.

- The transformer must be connected to the 12V AC/DC input for this procedure.
- Remove the 4 screws that fasten the RC1-SS Receiver lid in place. **CAUTION:** Remove the lid carefully, because there is a ribbon cable from the keypad to the circuit board inside. Do not disconnect this ribbon cable.
- Switch power to transformer on. The output from the RC1-SS should be off, with the Power LED off.
- Press the self-learning switch to the right of the green LED on the RC1-SS circuit board. See the drawing below. The Power LED on the keypad will switch on.
- **WITHIN 5 SECONDS**, press the desired button on the RC-3T transmitter. When the Power LED goes out, press the **SAME** button on the RC-3T transmitter a second time, within 5 seconds.
- The Power LED will give 8 quick flashes to confirm the new button assignment. For multiple pool light installations, as many receivers can be “learned” to the same RC-3T button as required, so that all lights are switched on and off with one button.

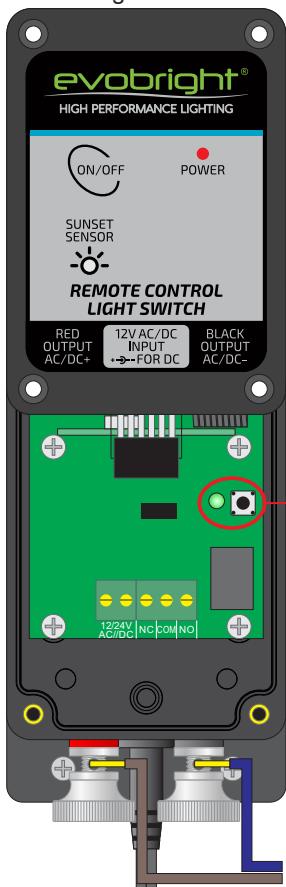

Press Self-learning switch **FIRST**.



Press desired button on the RC-3T transmitter **twice SECOND**.

Wiring for multiple pool lights and other 12VAC/DC electrical devices :

The wiring examples we have shown below illustrate two important points about the electrical installation :

- Firstly, it shows the correct way to wire two or more pool lights, where each light is wired to its own remote control receiver and transformer. When the lights are installed in this way, it is possible to use the Self Learning function (page 5) to assign all the lights to one On/Off button on the remote control transmitter.
- Secondly, we have shown how additional devices, such as landscape lighting and a water feature, can be installed with their own remote control receivers, and assigned the own On/Off buttons on the same remote control transmitter.

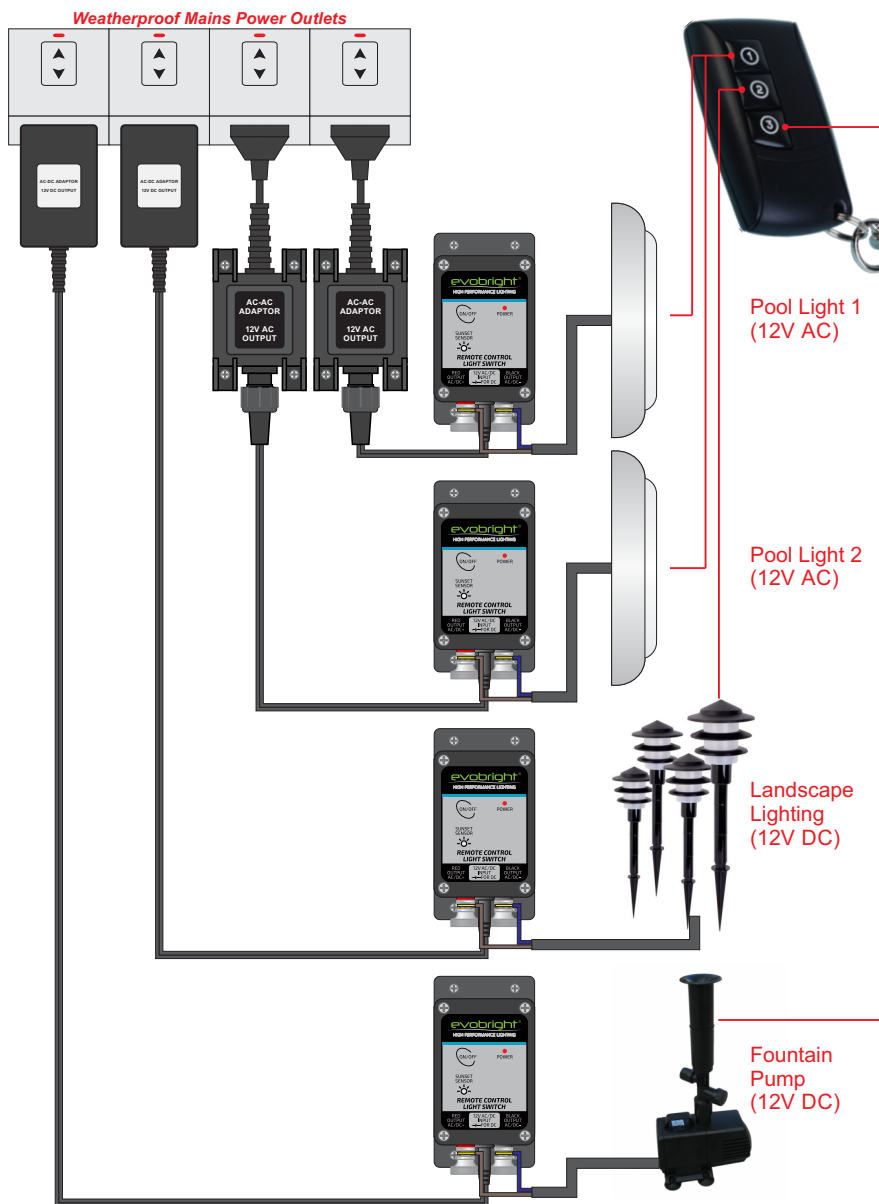

Replacing the Battery in RC-3T Remote Control Transmitter

- Lever the two halves of the enclosure apart using a coin in the slot at the end of the RC-3T.
- Lay the two halves flat as shown below, with the circuit board and battery correctly slotted into the plastic pins of the enclosure. Replace the battery with a 23AE 12V alkaline type. DO NOT use a rechargeable battery, which is likely to leak and cause corrosion in the long term.
- Re-confirm that the circuit board is fitted onto the plastic pins of the enclosure correctly.
- Leaving the half of the enclosure with the circuit board lying flat, bring the other half of the enclosure over and lay it on top. Squeeze together firmly with your fingers until the two halves snap into place all the way around.



Warranty

Evolution Water & Lighting Systems ("Evolution WLS") guarantees the RC1-SS Remote Control Receiver and RC-3T Remote Control Transmitter to be free from defects in material and workmanship when subjected to normal use and service. This guarantee is expressly limited to the repair of a faulty device returned to Evolution WLS, or Authorised Service Agent, freight prepaid, within two (2) years from the date of delivery, and to the repairing, or replacing of parts which upon inspection are found to be defective. The battery inside the RC-3T remote control is not covered by warranty.

There are no expressed or implied warranties which extend beyond the face hereof, and Evolution WLS is not liable for any incidental or consequential damages arising from the use or misuse of this product. This limited warranty does not apply to any injury, loss, damage, defect or malfunction of the product or failure to function resulting from any failure to operate the product in accordance with the directions contained in the operating instructions, failure to function resulting from any accidents, acts of God, tampering, abuse, acts, omissions, or negligence by anyone other than Evolution WLS, including but not limited to such damage or injuries resulting from improper installation. Damage from excessive concentration of one or more chemicals is not covered by this warranty.

This limited warranty shall apply only to the Customer as an original purchaser. It is the customer's responsibility to follow safety regulations and laws regarding electrical installation. Shipping damage is not covered by this warranty.

No claims will be recognised without the proof of purchase. This warranty becomes invalid if unauthorised person or persons attempt modifications or repairs.

To obtain warranty service or repair, please contact the distributor or reseller from whom you purchased the product. If the reseller is not able to assist you, then please email the following information to repairs@evolutionwls.com.au, and we will contact you to make arrangements.

- **Your Name**
- **Your telephone number**
- **Your Email address**
- **Your return street address**
- **Proof of Purchase (photocopy or scanned copy is acceptable)**
- **A description of the fault. This is very important, since it will enable us to address your issue more quickly, sometimes without even having to return the product to us.**

Your equipment will be repaired and returned to you as soon as possible. For out-of-warranty units, a repair cost will be calculated from parts and labour costs. Your warranty does not include onsite services.

Any dispute between customer & Evolution WLS must be conducted in Queensland, Australia

Contact Information

Evolution Water & Lighting Solutions

Unit 1, 33 Hinkler Dr
Highland Park, Qld. 4211

Tel.....07 5565 0000

Emailenquiries@evolutionwls.com.au

Web.....evolutionwls.com.au

evolution
WATER & LIGHTING SOLUTIONS